Operation Manual



Wall-O-Lite DMX



KINO FLO

L I G H T I N G S Y S T E M S

Assembly and Features



CFX-W48-X120.....Wall-O-Lite Fixture,
DMX 120 VAC

CFX-W48-X230.....Wall-O-Lite Fixture,
DMX 230 VAC



W48-F Accessory Frame

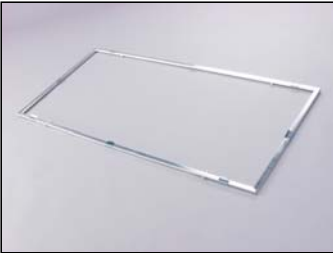

GFR-W48.....Gel Frame

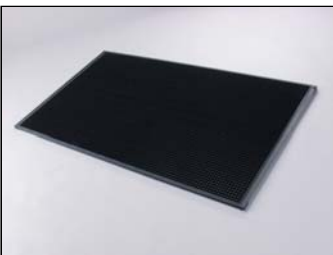

LVR-W48.....Louver / Black



W48-FB.....Frame Bracket with
Thumb Screw x 4

Inserting Lamps

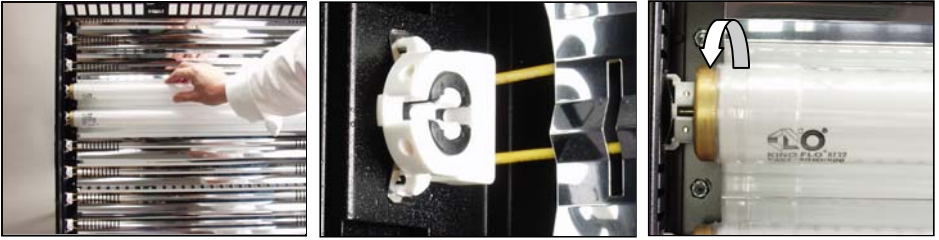

Insert lamps into both lamp holders. Twist $\frac{1}{4}$ turn to make electrical contact.

Mounting Accessory Frame

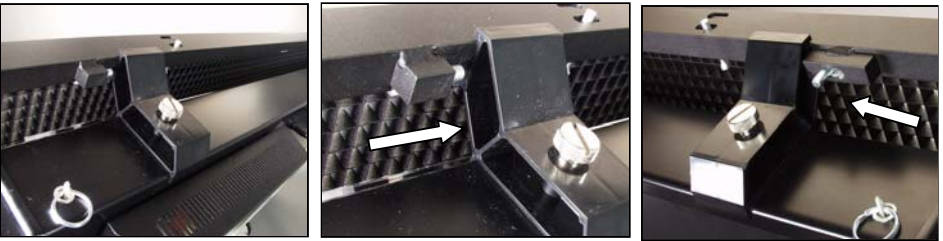

- Align the two fixed pins of the Accessory Frame with the Frame Brackets.
- Slide the Frame forward to seat the pins into the Brackets.
- Retract the sliding pins on the Frame to properly seat the Frame on the Brackets.
- Release the pins to lock the Frame in place.

Inserting Gel Frame



The gel frame is secured to the fixture by 4 spring-loaded pins. Align the pins of the gel frame with the oval receptacle holes on the edge of the fixture. Pull back the pins and release into the receptacles to properly secure the gel frame.

Applying Gel to Frame

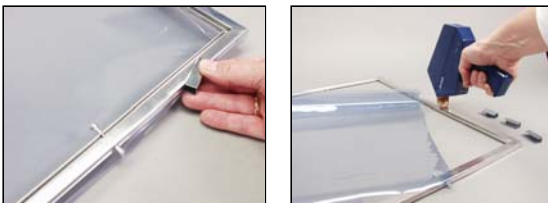

(A)

(B)

A) The Gel Frame comes with Gel Clips. Cut the gel to size and use the Clips to fasten the gel to the Frame.

B) Another method is to apply transfer tape directly to the gel frame. The clips are not necessary when taping the gel.

Inserting Louver

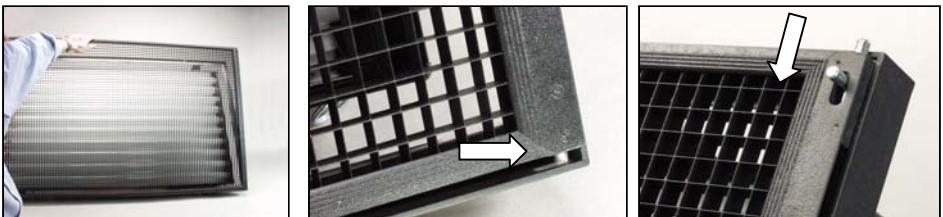

Place the long edge of the Louver with the fixed pins into the Frame. The fixed pins fit into receptacle holes on each corner of the frame. Align the upper corners of the Louver to the Frame. Retract the movable pins to properly seat the Louver. Release the pins to lock in place.

Mounting Options



The Wall-O-Lite can be mounted to a Junior Combo stand or hung from a pipe hanger. The Junior Mount that is included with the fixture is used when mounting on a stand.

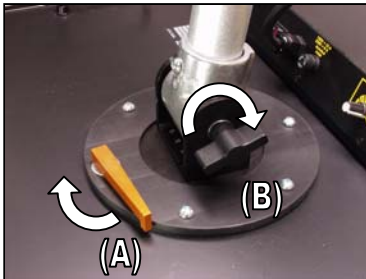

Rotation and Tilt Controls

- A)** The golden lock lever controls the rotation of the fixture.
- B)** The black knob controls the tilt.



Accessory part #MTP-WH is used to operate the mount from a Junior Pipe Hanger.



Environmental: Disposal of Old Electrical & Electronic Equipment.



This symbol on the product or on its packaging indicates that this product shall not be treated as household waste. This product is made of recyclable materials and should be disposed of in accordance with local and state regulations.

Rev 10-04-2005
Part No. 3100021

Kino Flo, Inc. 2840 N. Hollywood Way, Burbank, CA 91505, USA
Tel: 818 767-6528 website: www.kinoflo.com